

Autovista

FITTING A BREWER SERVICE KIT

**HIGH
PRESSURE
BREWER**



westomatic
make it happen

Fitting a Brewer Service Kit

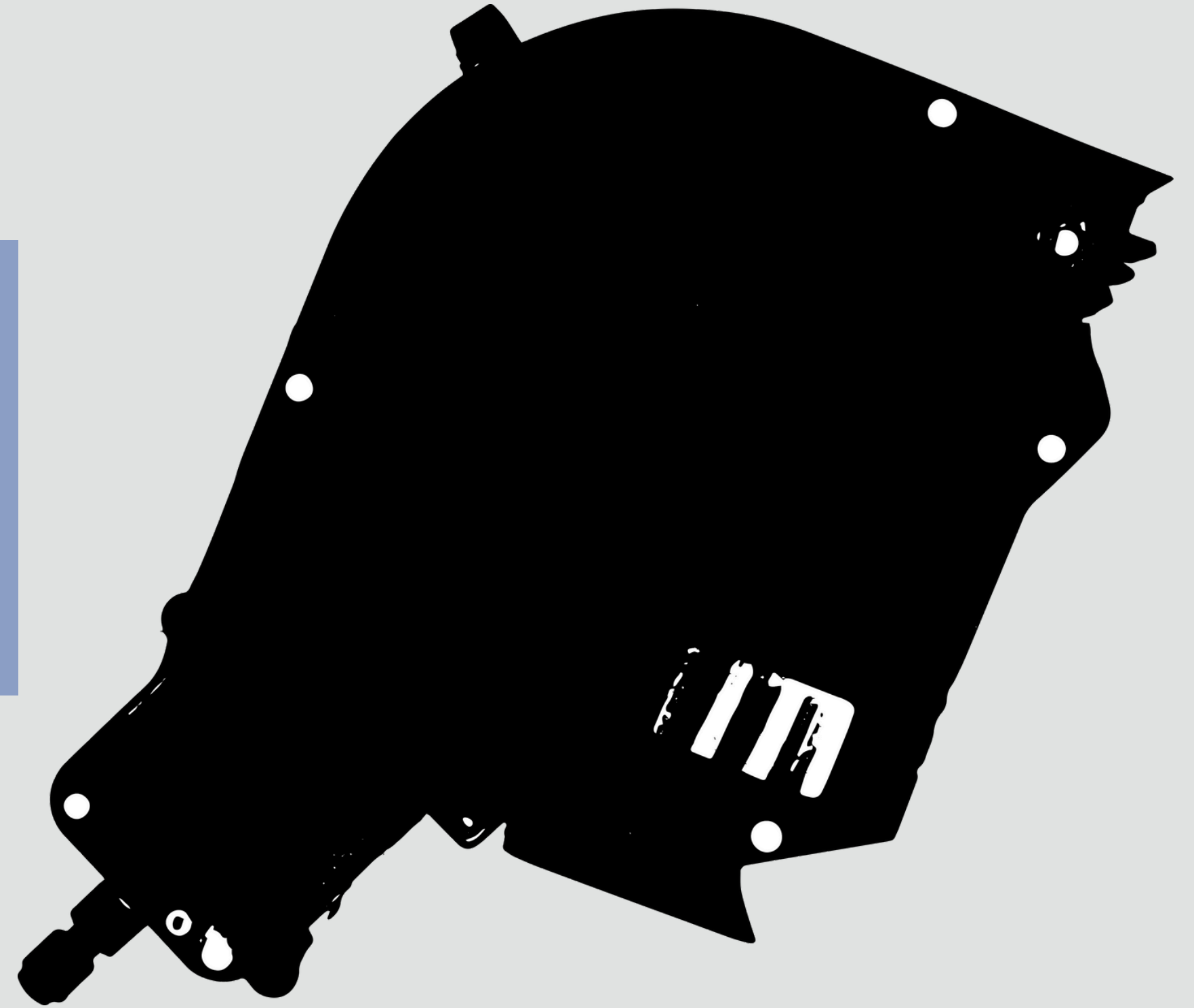

EQUIPMENT NEEDED:



- Flathead Screwdriver
- Crosshead Screwdriver
- 7mm Socket
- Thin nose Pliers
- Brewer Lube

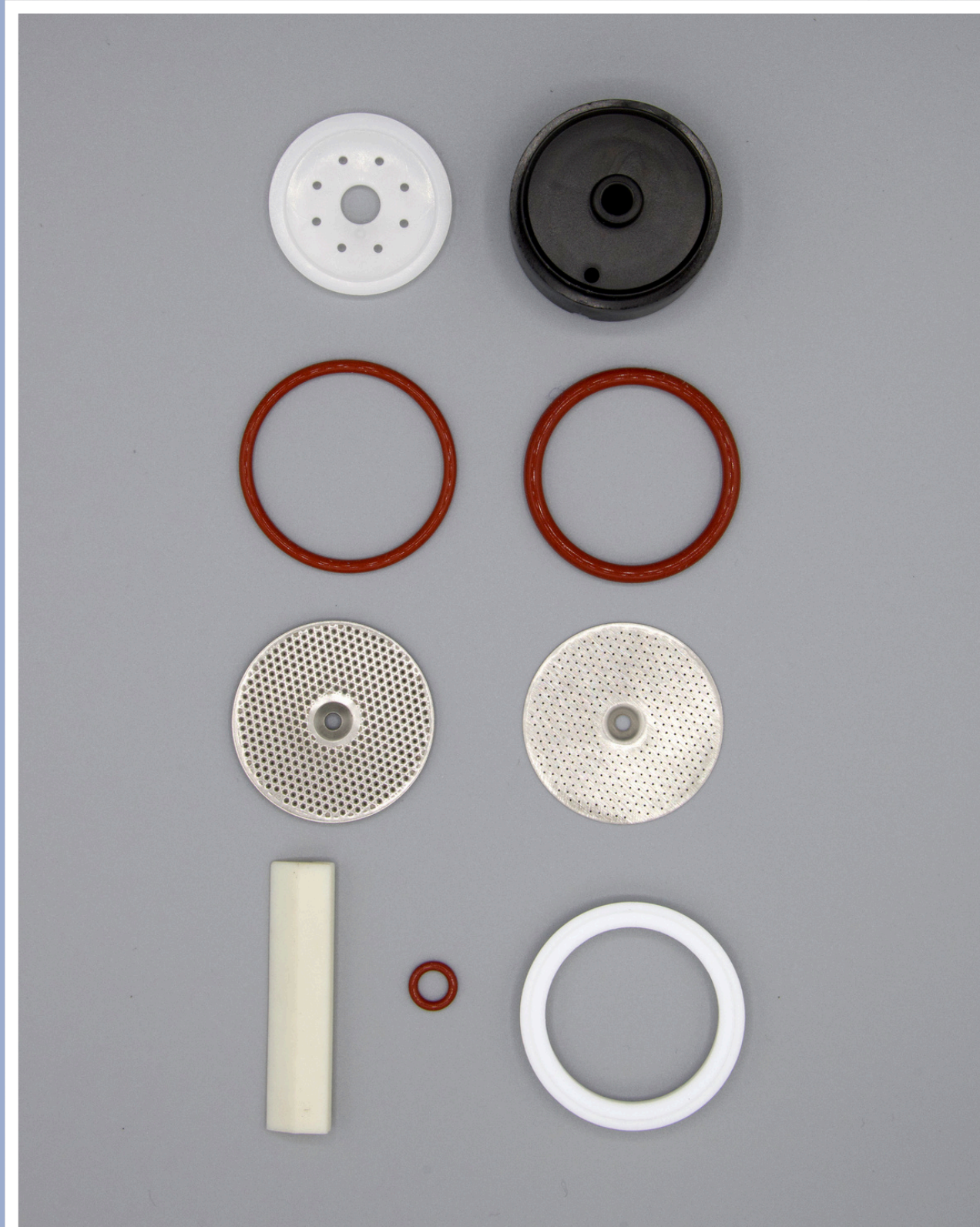

44mm HP BREWER
PN: 2099509

1

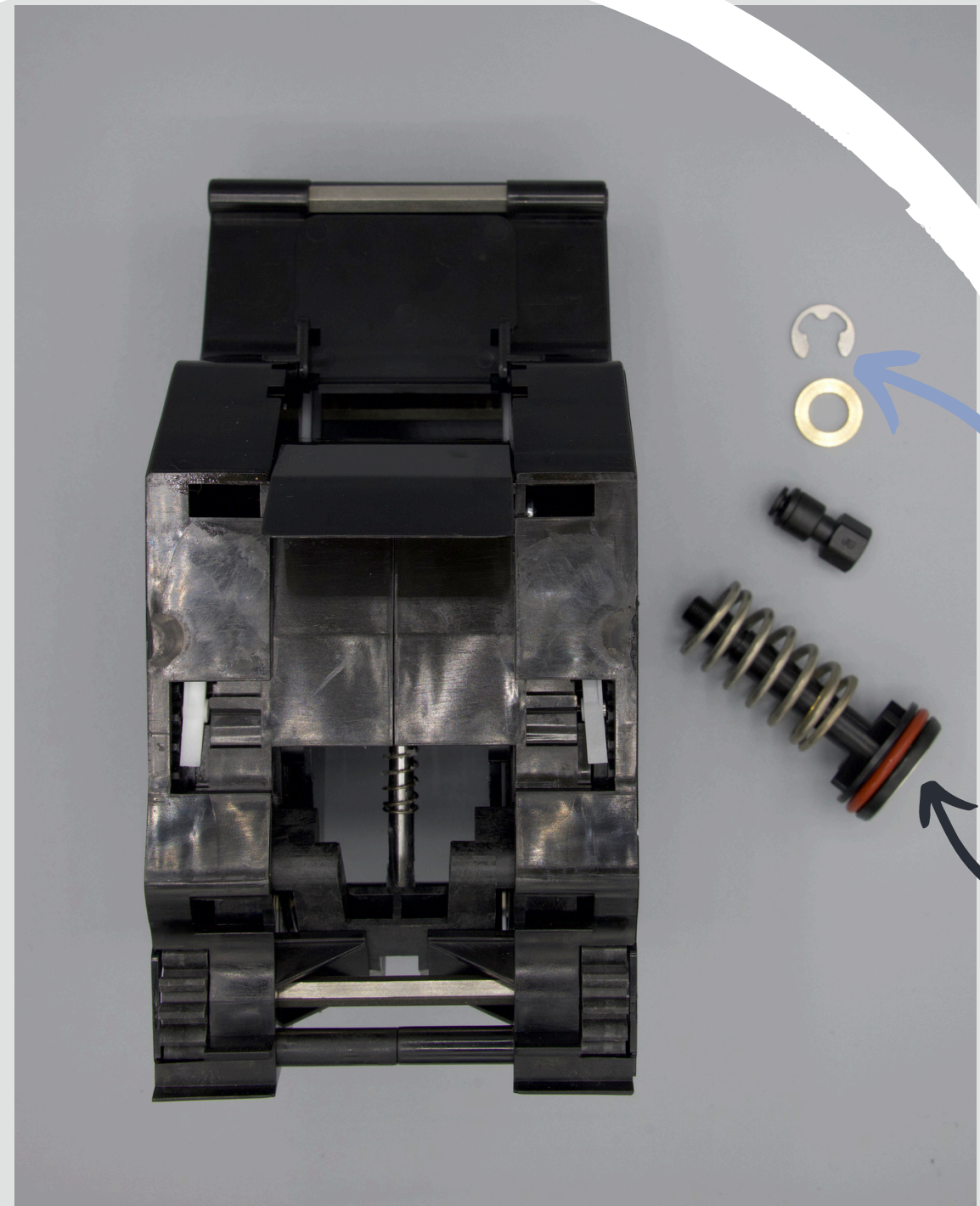
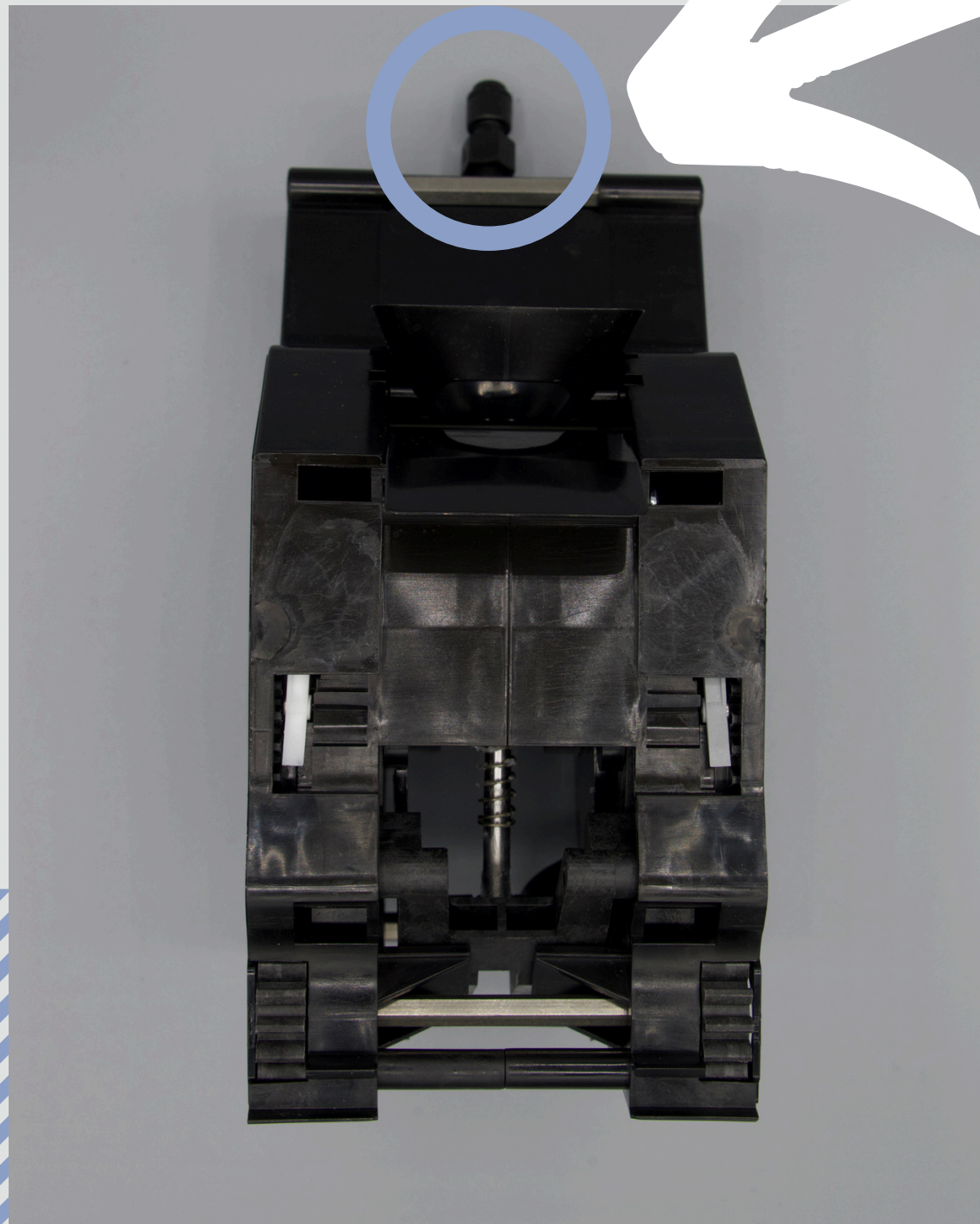

REMOVE UPPER PISTON

- 1. Remove quick release fitting**
- 2. Unclip collar**
- 3. Remove Upper Piston + Spring**

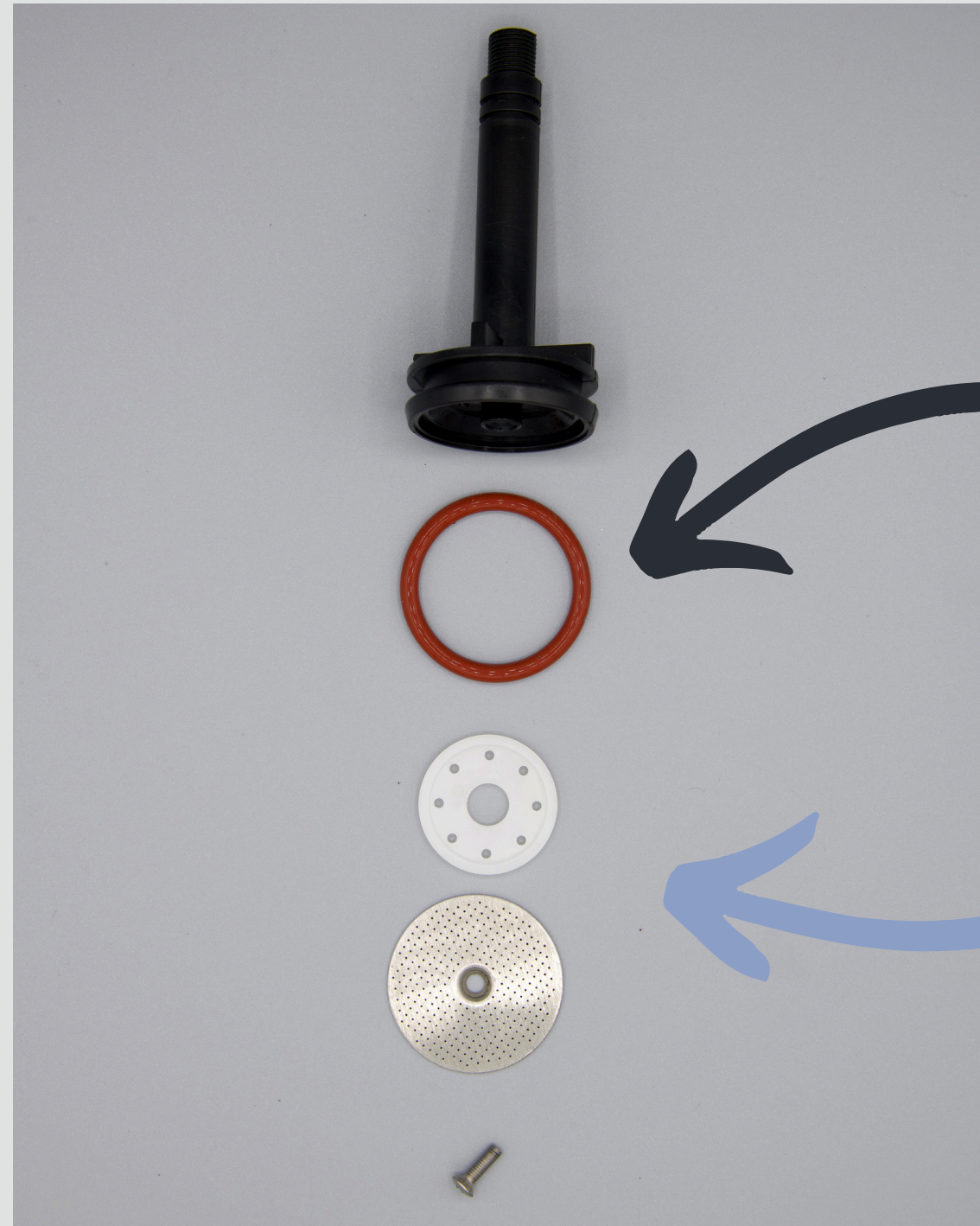

- 1. Remove Screw**
- 2. Replace O Ring**
- 3. Replace Filters**

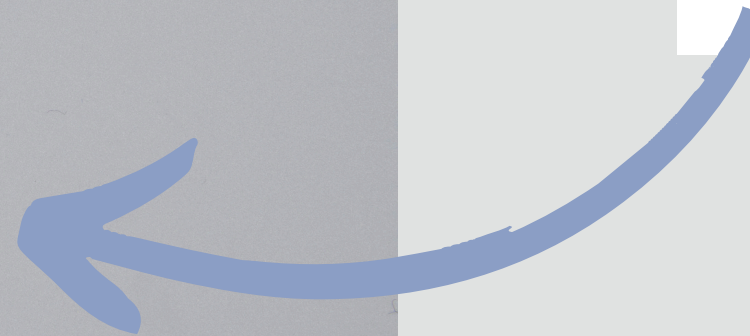

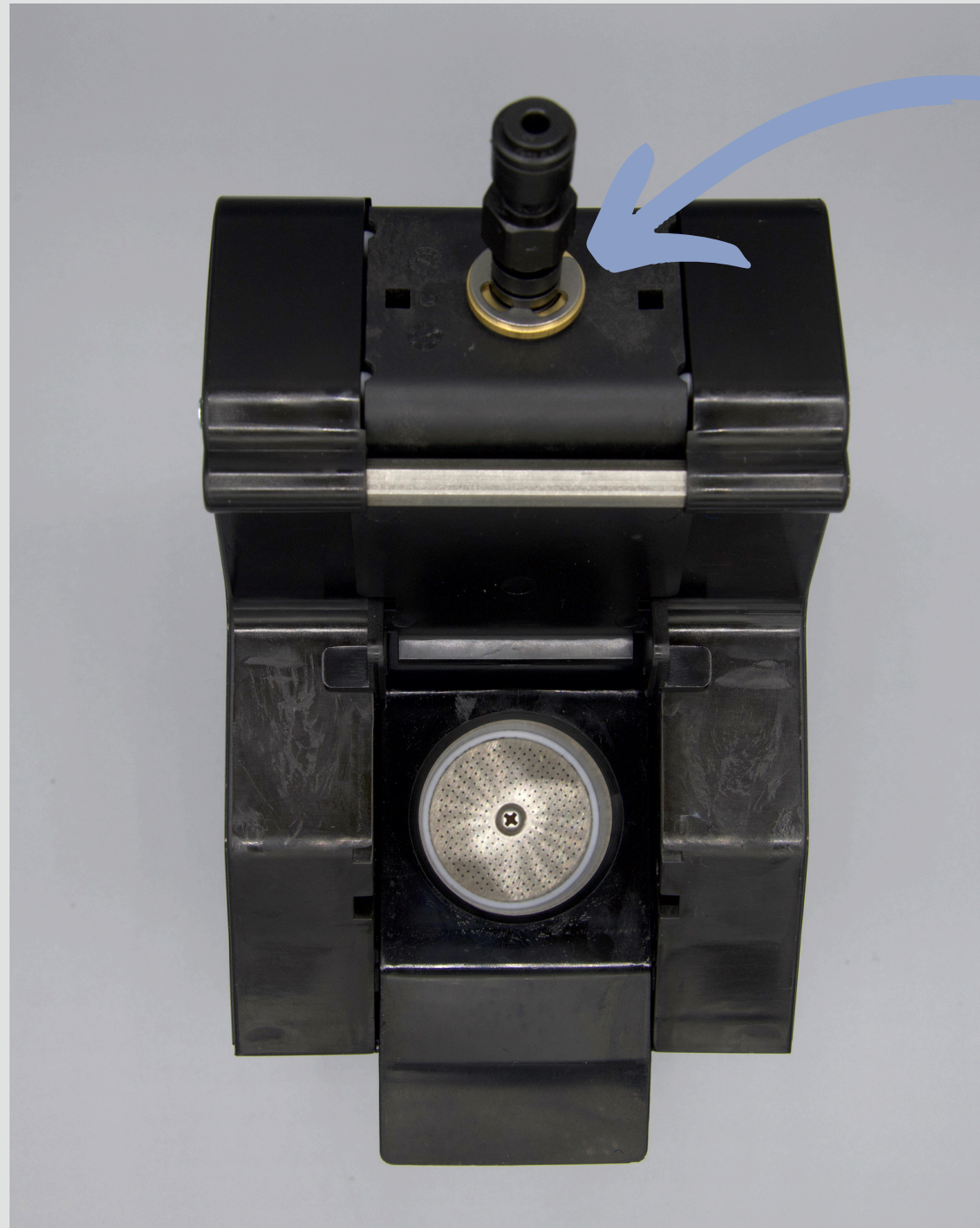

- 1. Replace spring onto upper piston**
- 2. Insert Piston back into place**
- 3. Replace Washer & Clip**
- 4. NB - Place clip into lower groove for correct fit**
- 5. Replace quick release Fitting**

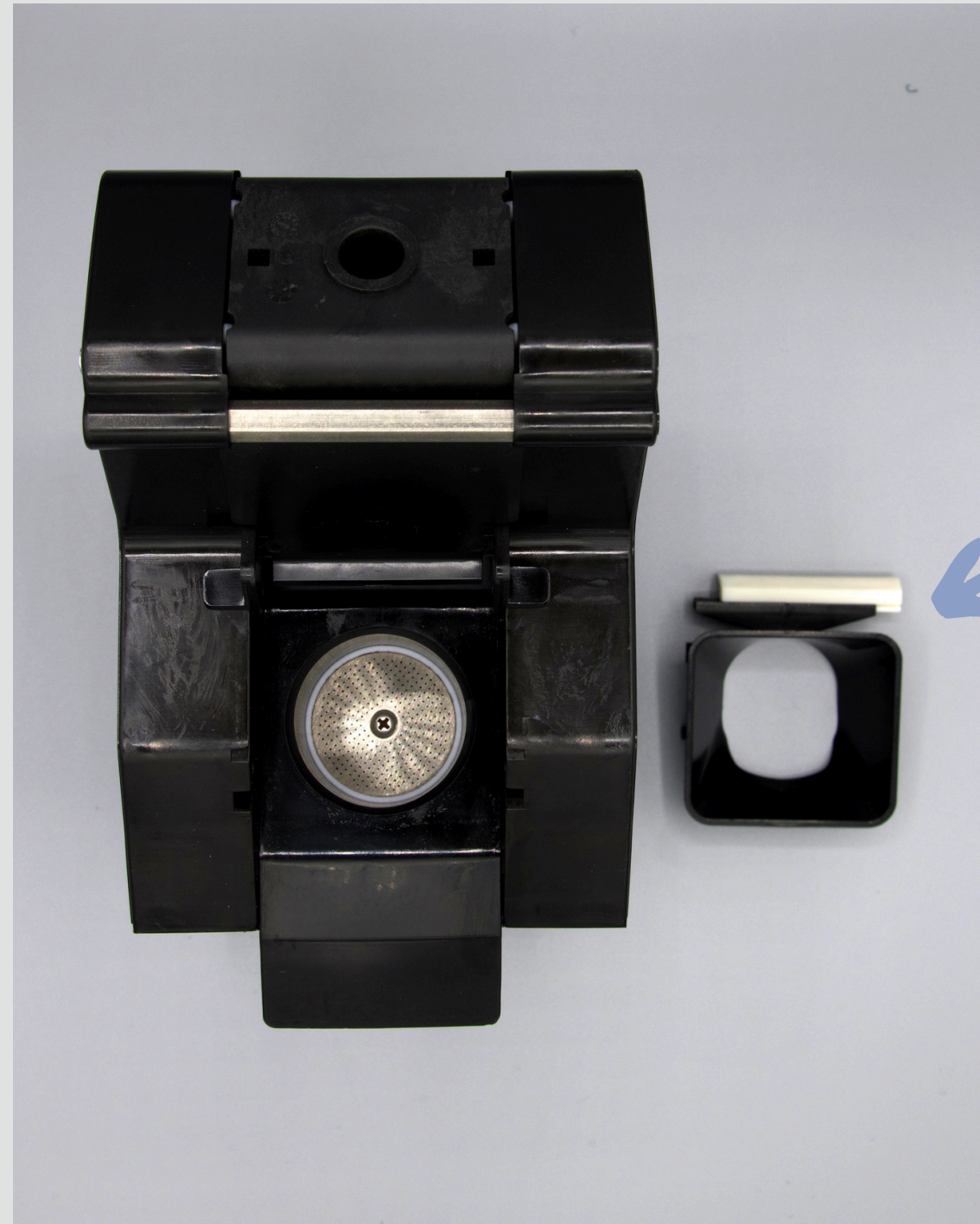

REPLACE WIPER BLADE

- 1. Remove Brewer chamber cap**
- 2. Replace Wiper Blade**
- 3. Wipe clean chamber cap**

3

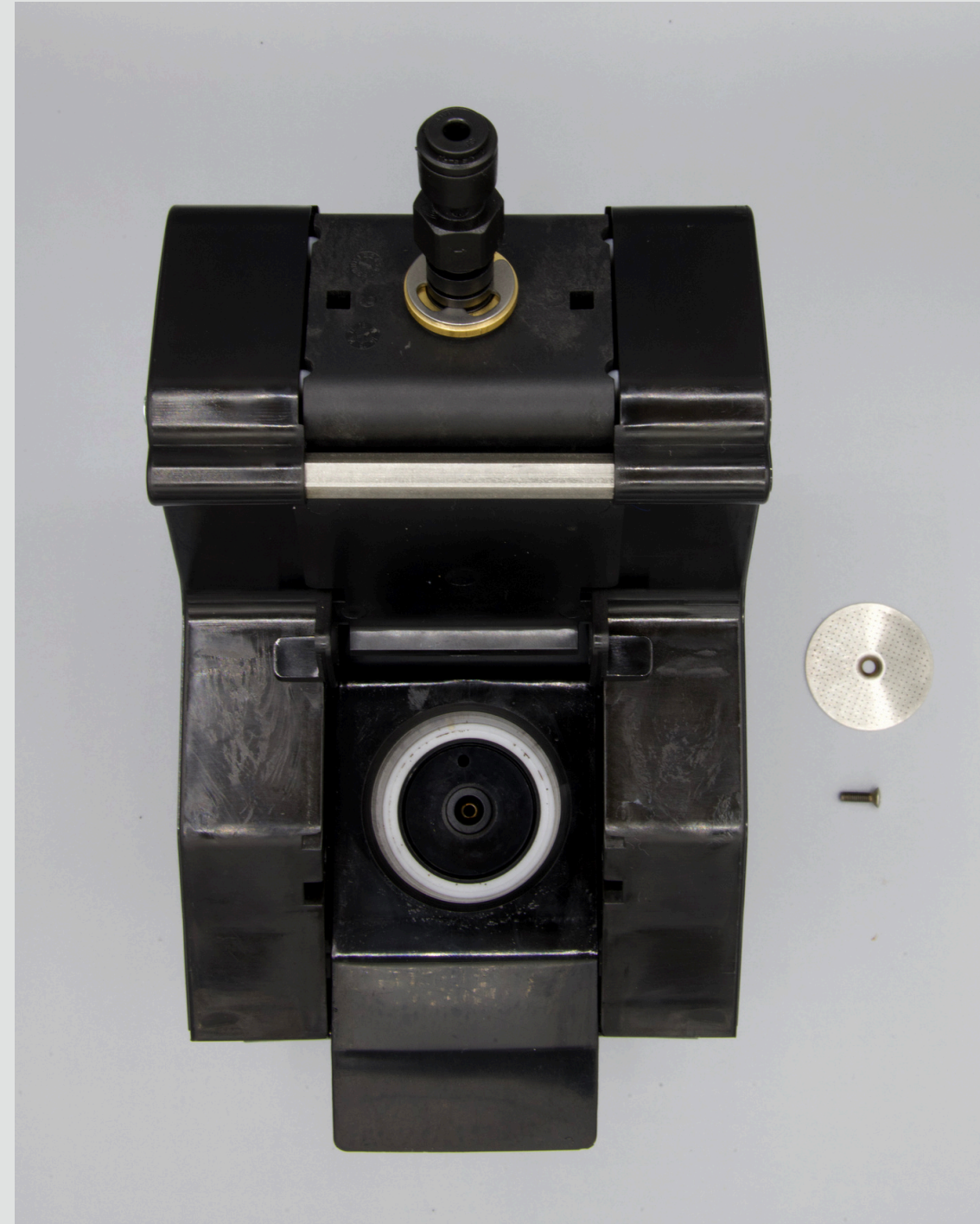

REMOVE LOWER PISTON

- 1. Remove Screw**
- 2. Remove Filter**

3

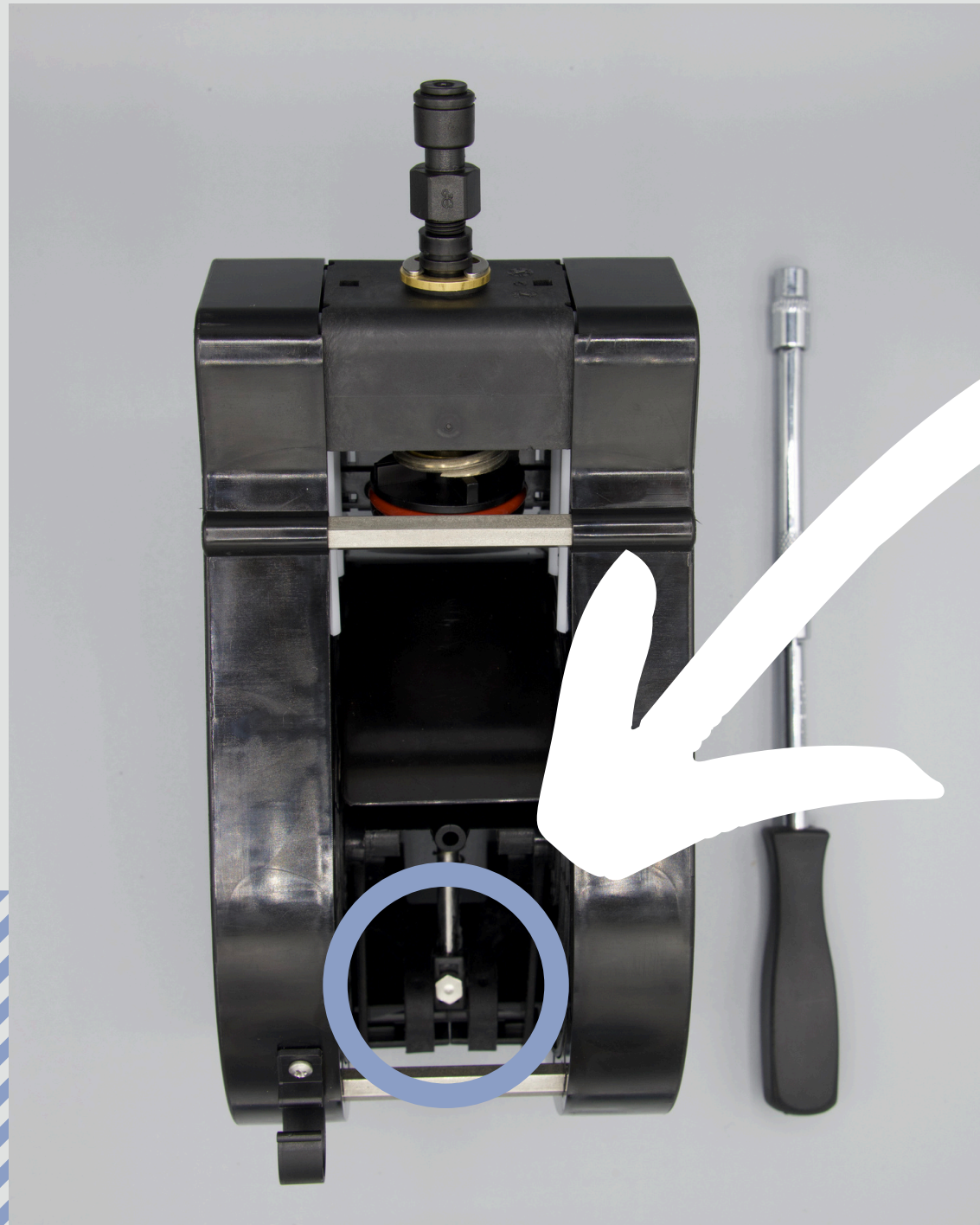

REMOVE LOWER PISTON

1. Using the socket wrench remove screw
2. Using the fixing rod - screw to remove plunger

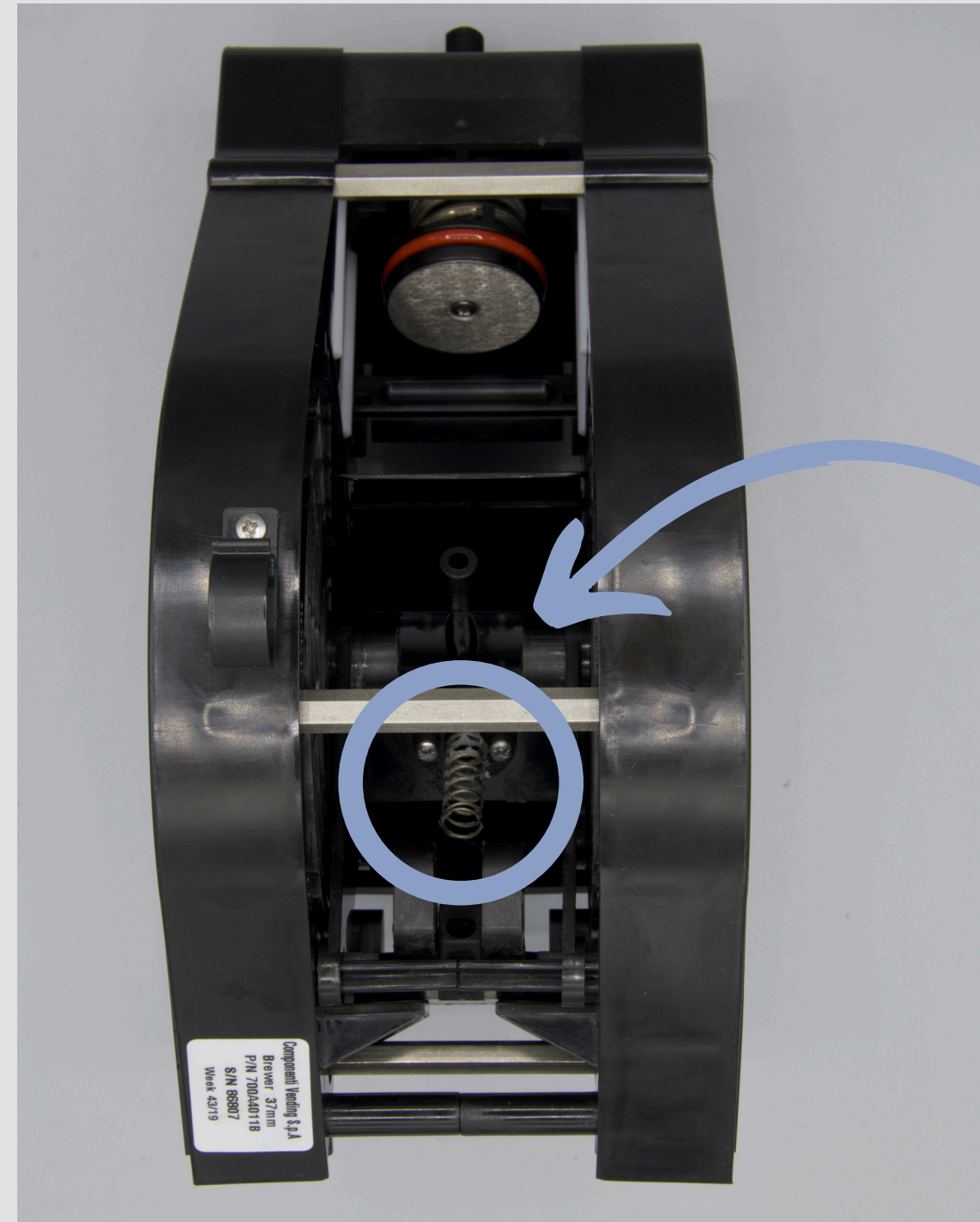
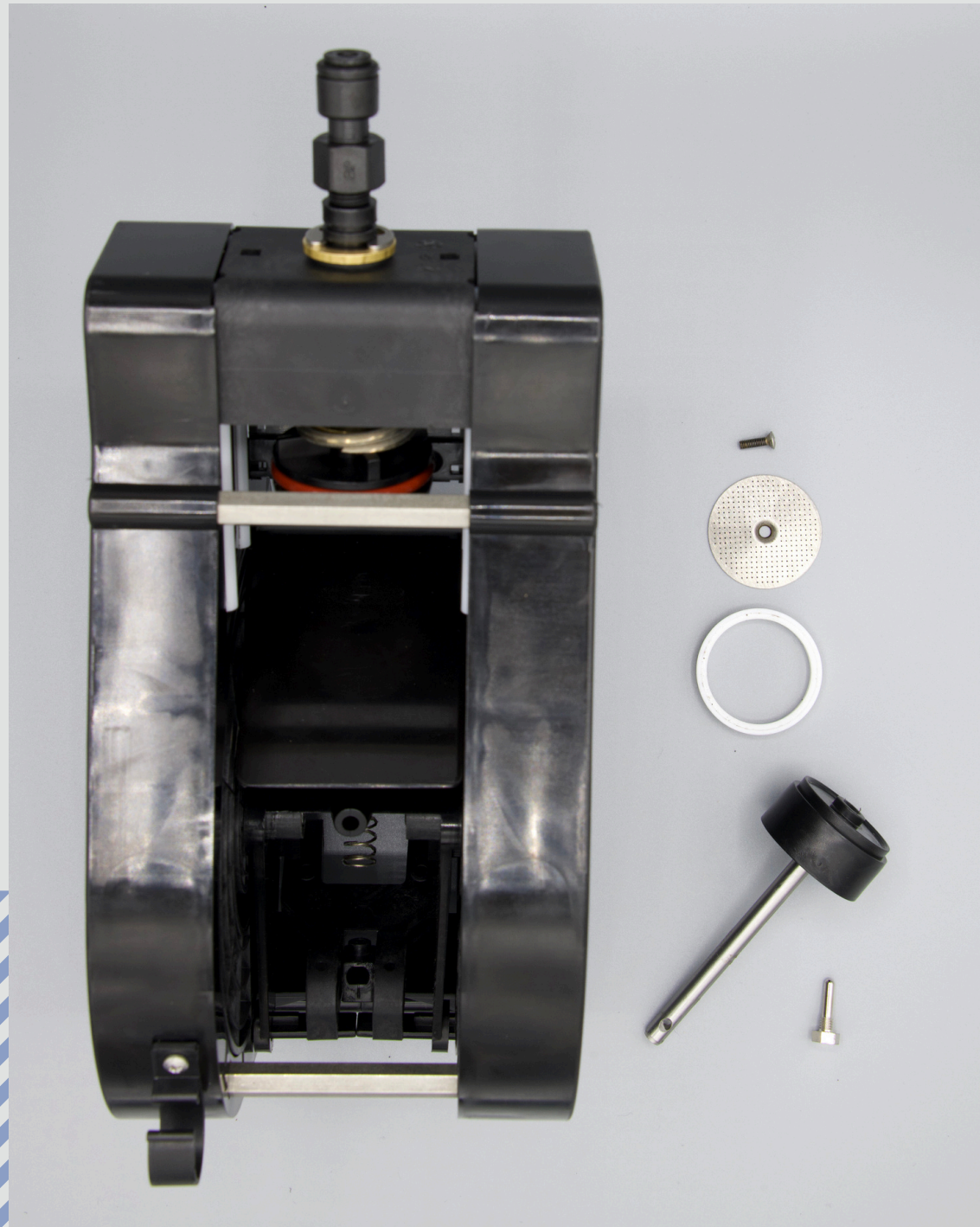

- 1. Remove the piston spring**
- 2. Remove 2 x screws and cap**

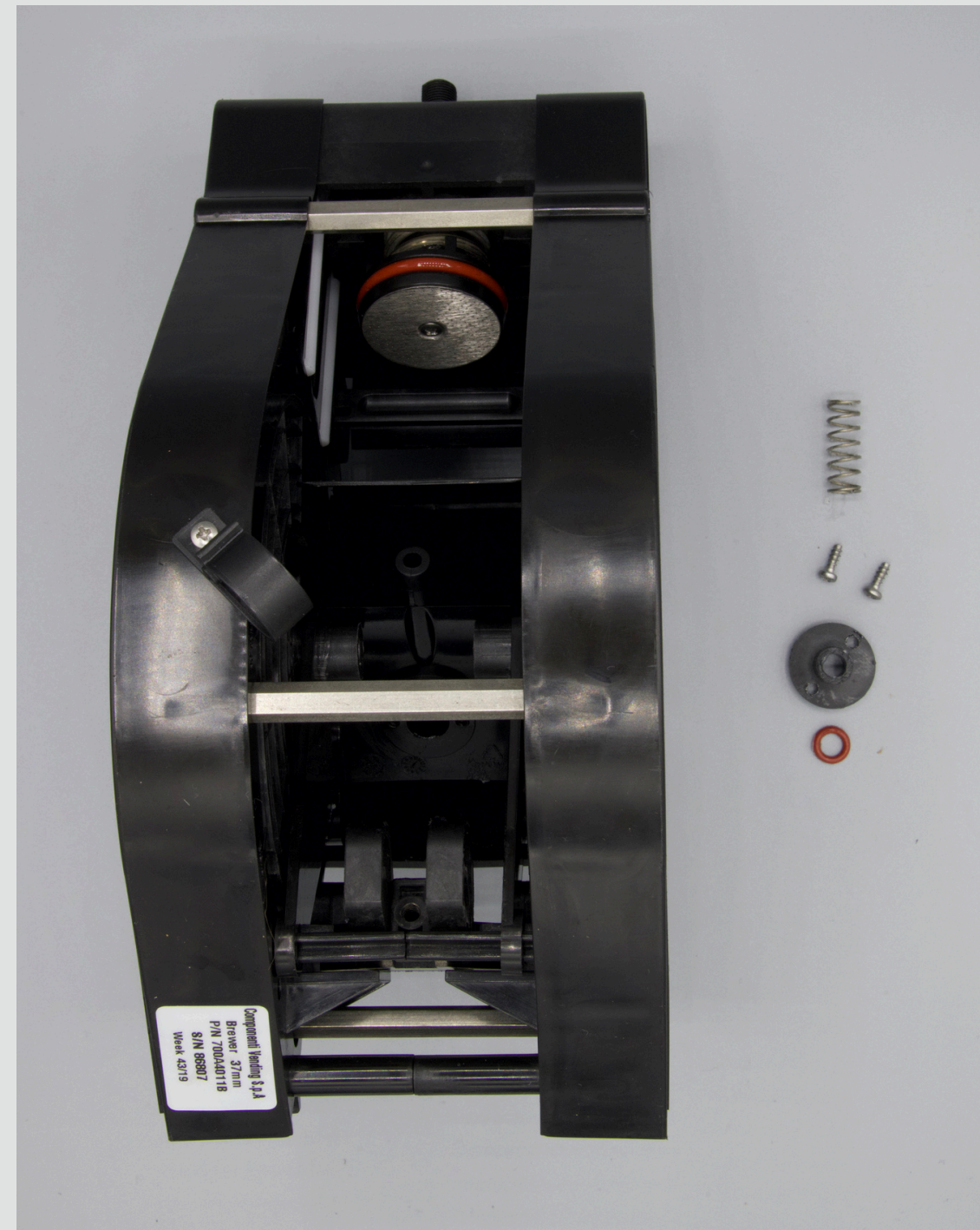

- 1. Replace the small O Ring**
- 2. Reassemble lower piston assembly**
- 3. Spray the piston rod with lubricant**

Autovista



westomatic
make it happen